

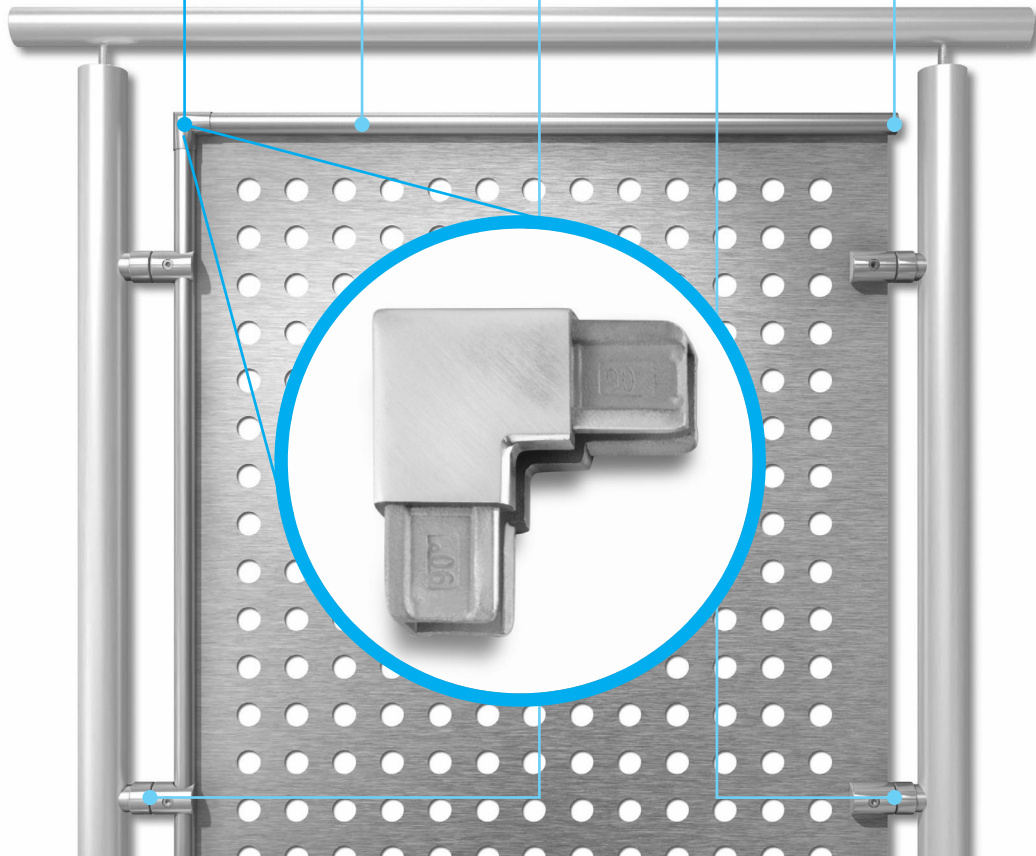

Corner connector LE 12x18

Figure drawn to scale 1:1

Corner connectors
Profile edgings
Profile brackets
Panel brackets
Profile end cap



Available materials



Fine zinc alloy



Stainless steel cast alloy

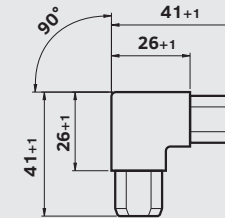

Suitable for profile edging LE 12x18



WITH A SINGLE CLICK
TO OUR ACCESSORIES!

Discover the appropriate range of accessories online in our shop. Simply enter "Accessories" in the online search.

